



**MICROTECH**

PRECISION CUTLERY SINCE 1994



## BELT CARE

Minimal maintenance is required for our belt buckles to continue buckling and releasing smoothly. Be sure to keep the buckle clear of dirt or debris. If needed, put a few drops of light gun oil on the inner locking teeth, then blow it out with compressed air.

## BELT WARRANTY & REPAIR

Disassembly will not automatically void the warranty. These actions will void the warranty if the function of the buckle is altered. We recommend customers send their buckles to us and let our technicians take care of cleaning/oiling services and warranty issues. The first step for any service or warranty issues is to fill out the support ticket form at [support.microtechknives.com](https://support.microtechknives.com).

## ONLINE RESOURCES

Additional help, articles and videos available online at [support.microtechknives.com](https://support.microtechknives.com).

FIND US ON



@microtechknivesofficial

## OPTIONAL PRODUCT REGISTRATION

We suggest you register your product online at [microtechknives.com](https://microtechknives.com). This registration is not required for warranty coverage, but is helpful for our customer service efforts.

*WARNING! This product may contain a chemical known to the state of California to cause cancer, birth defects or other reproductive harm.*

*Microtech® and its designs are registered trademarks of Microtech® Knives Inc. All rights reserved. Any unauthorized reproduction of any materials herein is strictly prohibited by law.*



**APIS™  
PRODUCT MANUAL**



**MICROTECH®**

## WELCOME TO THE MICROTECH® FAMILY

Thank you for choosing Microtech®. We believe that when you purchase a Microtech® item, you have bought the best. Our talented associates work hard to ensure that every product surpasses your expectations. We stand behind our premium materials and quality craftsmanship. For more information on Microtech® and our mission, please visit us at [microtechknives.com](http://microtechknives.com).

## LIMITED LIFETIME WARRANTY

Our warranty covers the function of the product (including internal parts) for the lifetime of the product, based on availability. Our warranty does not cover normal signs of wear and tear, cosmetic refurbishments, replacement parts, accidents, loss or theft.

For any warranty-related inquiries, visit our support portal at [support.microtechknives.com](http://support.microtechknives.com).

## OPERATION

**TO BUCKLE:** Align the locking shaft (A) with the receiver (B) and push the two components together until they lock securely. You will hear the locking teeth click when they are securely fitted together.

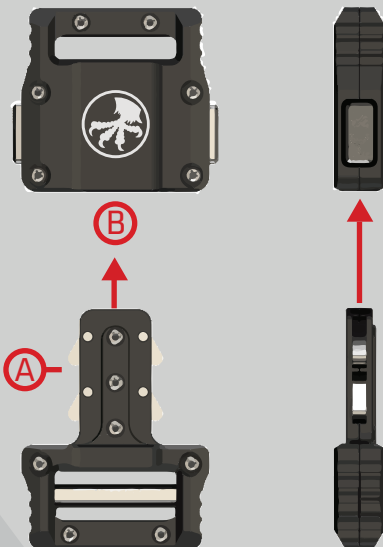

**TO OPEN:** Depress the two buttons on the side of the buckle receiver (C) inwards with the thumb and pointer fingers to release the buckle lock. Then, simply separate the two components.

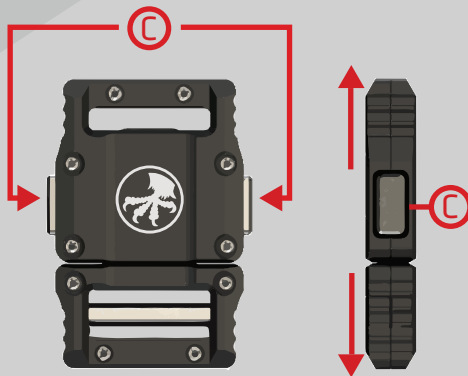

## THREADING BELT STRAP

To attach the supplied belt strap to the buckle, thread the end of the strap through slot (D) from the back side upwards. Next, feed the end of the belt strap back down through slot (E), and adjust for length.

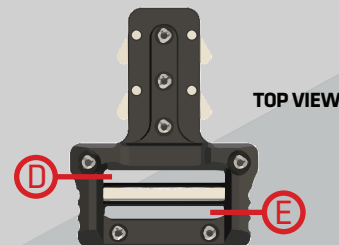

SIDE VIEW

